

SKINDICHT® SK

Nickel-plated brass strain relief with double saddle clamp and PG thread

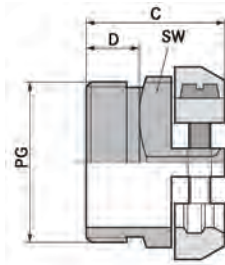

Complete the installation

SKINDICHT®
SM locknuts
page 542

The SKINDICHT® SK cable gland is equipped with two nickel-plated brass saddle clamps that guarantee reliable strain relief.

■ Application advantage

- Durable, compact, and corrosion-resistant cable clamp
- The double saddle clamp arrangement accommodates a wide range of cables that are clamped concentrically

■ Approvals



■ Technical data

Material:		Locknuts:	add SKINDICHT® SM, page 542
- body:	nickel-plated brass	Temperature range:	-20°C to +200°C
- brackets:	nickel-plated brass	IP Protection:	IP20
- screws:	nickel-plated brass		

Part number	Thread	Clamping range (øF)		Wrenching flats (SW) in	Overall length (C) in	Thread length (D) in	Max. installation diameter in	Pack size
		in	mm					
52004230	PG 9	0.236 - 0.472	6.0 - 12.0	0.75	0.650	0.236	0.945	50
52004240	PG 11	0.276 - 0.591	7.0 - 15.0	0.83	0.650	0.236	1.063	50
52004250	PG 13	0.472 - 0.650	12.0 - 16.5	0.87	0.728	0.295	1.181	25
52004260	PG 16	0.512 - 0.709	13.0 - 18.0	0.94	0.748	0.295	1.300	25
52004270	PG 21	0.591 - 0.906	15.0 - 23.0	1.18	0.886	0.315	1.654	25
51712740	PG 29	0.788 - 1.221	20.0 - 31.0	1.61	1.024	0.315	2.285	10